



November 7, 2016

Mr. James Kolodziej
Director of Physical Plant & Operations/Purchasing
Community High School District #99
6301 Springside Avenue
Downers Grove, IL 60516

Wight & Company

wightco.com

.....
2500 North Frontage Road
Darien, IL 60561

.....
P 630.969.7000

F 630.969.7979

**LEAD IN POTABLE WATER STUDY
DOWNERS GROVE SOUTH HIGH SCHOOL**

Dear Mr. Kolodziej:

Wight & Company was retained by Community High School District #99 to provide a limited lead in potable water study for Downers Grove South High School kitchen and serving area.

The health effects of lead in the body can cause serious damage to all of the systems. The three most affected systems are the central and peripheral nervous system, cardiovascular system and the kidneys. Excessive exposure to high concentrations of lead can cause retardation (learning disabilities) and more serious health problems. Children are the most susceptible to lead poisoning. The "United States Environmental Protection Agency" (USEPA) has established an action level of 15 PPB (parts per billion) of lead in water as the maximum safe level for potable water consumption by humans.

Sampling was conducted at the facility in accordance with established protocol. At the facility no water was used for several hours prior to the sampling, which allows for leaching of lead from the valves or piping into the water. After the waiting period, the method was to obtain a first draw of one liter of water followed by a second draw of 250ml of water immediately following the first draw at each location where drinking water could be consumed. The samples were transported to First Environmental Laboratories, Inc. in Naperville an IL ELAP/NELAC accredited laboratory for analysis of lead in water.

The results indicated all of the faucets sampled were <.005 mg/L (less than) or expressed in parts per billion <5 PPB with one exception. Sample #DGS6A recorded a level of .008 mg/L or 8 PPB which is well below the action level of 15 PPB. The results are that all sources sampled are in compliance with <15 PPB. Please refer to the facilities laboratory results attached.

Thank you for having Wight & Company provide this important service to Community High School District #99.

Respectfully Submitted,

Roger Genschoreck
IDPH Lead Inspector #007300

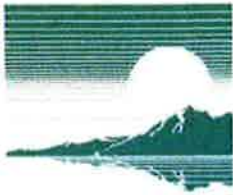

**First
Environmental
Laboratories, Inc.**

IL ELAP / NELAC Accreditation # 100292

1600 Shore Road • Naperville, Illinois 60563 • Phone (630) 778-1200 • Fax (630) 778-1233

November 07, 2016

Mr. Roger Genschoreck
WIGHT & COMPANY
2500 N. Frontage Rd.
Darien, IL 60561

Project ID: 05-5274-34 DGS High School Kitchen
First Environmental File ID: 16-6253
Date Received: November 03, 2016

Dear Mr. Roger Genschoreck:

The above referenced project was analyzed as directed on the enclosed chain of custody record.

All Quality Control criteria as outlined in the methods and current IL ELAP/NELAP have been met unless otherwise noted. QA/QC documentation and raw data will remain on file for future reference. Our accreditation number is 100292 and our current certificate is number 003811: effective 02/17/2016 through 02/28/2017.

I thank you for the opportunity to be of service to you and look forward to working with you again in the future. Should you have any questions regarding any of the enclosed analytical data or need additional information, please contact me at (630) 778-1200.

Sincerely,

Stan Zaworski
Project Manager

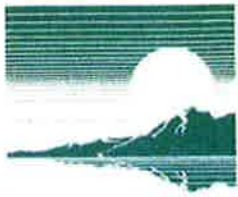

Case Narrative

WIGHT & COMPANY

Lab File ID: **16-6253**

Project ID: **05-5274-34 DGS High School Kitchen**

Date Received: **November 03, 2016**

All quality control criteria, as outlined in the methods, have been met except as noted below or on the following analytical report.

The results in this report apply to the samples in the following table:

Laboratory Sample ID	Client Sample Identifier	Date/Time Collected
16-6253-001	DGS-1A	11/2/2016
16-6253-002	DGS-1B	11/2/2016
16-6253-003	DGS-2A	11/2/2016
16-6253-004	DGS-2B	11/2/2016
16-6253-005	DGS-3A	11/2/2016
16-6253-006	DGS-3B	11/2/2016
16-6253-007	DGS-4A	11/2/2016
16-6253-008	DGS-4B	11/2/2016
16-6253-009	DGS-5A	11/2/2016
16-6253-010	DGS-5B	11/2/2016
16-6253-011	DGS-6A	11/2/2016
16-6253-012	DGS-6B	11/2/2016
16-6253-013	DGS-7A	11/2/2016
16-6253-014	DGS-7B	11/2/2016
16-6253-015	DGS-8A	11/2/2016
16-6253-016	DGS-8B	11/2/2016
16-6253-017	DGS-9A	11/2/2016
16-6253-018	DGS-9B	11/2/2016
16-6253-019	DGS-10A	11/2/2016
16-6253-020	DGS-10B	11/2/2016
16-6253-021	DGS-11A	11/2/2016
16-6253-022	DGS-11B	11/2/2016
16-6253-023	DGS-12A	11/2/2016
16-6253-024	DGS-12B	11/2/2016
16-6253-025	DGS-13A	11/2/2016

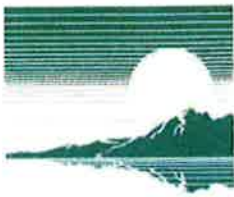

Case Narrative

WIGHT & COMPANY

Lab File ID: **16-6253**

Project ID: **05-5274-34 DGS High School Kitchen**

Date Received: **November 03, 2016**

All quality control criteria, as outlined in the methods, have been met except as noted below or on the following analytical report.

16-6253-026	DGS-13B	11/2/2016
16-6253-027	DGS-14A	11/2/2016
16-6253-028	DGS-14B	11/2/2016
16-6253-029	DGS-15A	11/2/2016
16-6253-030	DGS-15B	11/2/2016
16-6253-031	DGS-16A	11/2/2016
16-6253-032	DGS-16B	11/2/2016
16-6253-033	DGS-17A	11/2/2016
16-6253-034	DGS-17B	11/2/2016
16-6253-035	DGS-18A	11/2/2016
16-6253-036	DGS-18B	11/2/2016
16-6253-037	DGS-19A	11/2/2016
16-6253-038	DGS-19B	11/2/2016
16-6253-039	DGS-20A	11/2/2016
16-6253-040	DGS-20B	11/2/2016
16-6253-041	DGS-21A	11/2/2016
16-6253-042	DGS-21B	11/2/2016
16-6253-043	DGS-22A	11/2/2016
16-6253-044	DGS-22B	11/2/2016
16-6253-045	DGS-23A	11/2/2016
16-6253-046	DGS-23B	11/2/2016
16-6253-047	DGS-24A	11/2/2016
16-6253-048	DGS-24B	11/2/2016

Sample Batch Comments:

Time of sample collection was not provided.

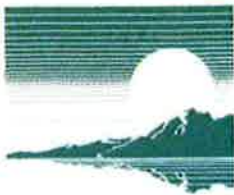

**First
Environmental
Laboratories, Inc.**

IL ELAP / NELAC Accreditation # 100292
1600 Shore Road • Naperville, Illinois 60563 • Phone (630) 778-1200 • Fax (630) 778-1233

Case Narrative

WIGHT & COMPANY

Lab File ID: **16-6253**

Project ID: **05-5274-34 DGS High School Kitchen**

Date Received: **November 03, 2016**

All quality control criteria, as outlined in the methods, have been met except as noted below or on the following analytical report.

Method Comments

Lab Number	Sample ID	Comments:
16-6253-011	DGS-6A	<i>Total Metals</i> Sample result was confirmed by re-analysis.

The following is a definition of flags that may be used in this report:

Flag	Description	Flag	Description
<	Analyte not detected at or above the reporting limit.	L	LCS recovery outside control limits.
C	Sample received in an improper container for this test.	M	MS recovery outside control limits; LCS acceptable.
D	Surrogates diluted out; recovery not available.	P	Chemical preservation pH adjusted in lab.
E	Estimated result; concentration exceeds calibration range.	Q	Result was determined by a GC/MS database search.
G	Surrogate recovery outside control limits.	S	Analysis was subcontracted to another laboratory.
H	Analysis or extraction holding time exceeded.	W	Reporting limit elevated due to sample matrix.
J	Estimated result; concentration is less than routine RL but greater than MDL.	N	Analyte is not part of our NELAC accreditation or accreditation may not be available for this parameter.
RL	Routine Reporting Limit (Lowest amount that can be detected when routine weights/volumes are used without dilution.)	ND	Analyte was not detected using a library search routine; No calibration standard was analyzed.



Analytical Report

Client: WIGHT & COMPANY
Project ID: 05-5274-34 DGS High School Kitchen

Date Received: 11/03/16
Date Reported: 11/07/16

Lab No:	Sample ID:	Analyte	Result	R.L.	Units	Flags
Total Metals		Method: 200.7R4.4	Preparation Method 200.7W			
16-6253-001	DGS-1A	Date Collected: 11/02/16	Time Collected:			
Analysis Date:	11/04/16		Preparation Date: 11/04/16			
	Lead		<0.005	0.005	mg/L	
16-6253-002	DGS-1B	Date Collected: 11/02/16	Time Collected:			
Analysis Date:	11/04/16		Preparation Date: 11/04/16			
	Lead		<0.005	0.005	mg/L	
16-6253-003	DGS-2A	Date Collected: 11/02/16	Time Collected:			
Analysis Date:	11/04/16		Preparation Date: 11/04/16			
	Lead		<0.005	0.005	mg/L	
16-6253-004	DGS-2B	Date Collected: 11/02/16	Time Collected:			
Analysis Date:	11/04/16		Preparation Date: 11/04/16			
	Lead		<0.005	0.005	mg/L	
16-6253-005	DGS-3A	Date Collected: 11/02/16	Time Collected:			
Analysis Date:	11/04/16		Preparation Date: 11/04/16			
	Lead		<0.005	0.005	mg/L	
16-6253-006	DGS-3B	Date Collected: 11/02/16	Time Collected:			
Analysis Date:	11/04/16		Preparation Date: 11/04/16			
	Lead		<0.005	0.005	mg/L	
16-6253-007	DGS-4A	Date Collected: 11/02/16	Time Collected:			
Analysis Date:	11/04/16		Preparation Date: 11/04/16			
	Lead		<0.005	0.005	mg/L	
16-6253-008	DGS-4B	Date Collected: 11/02/16	Time Collected:			
Analysis Date:	11/04/16		Preparation Date: 11/04/16			
	Lead		<0.005	0.005	mg/L	
16-6253-009	DGS-5A	Date Collected: 11/02/16	Time Collected:			
Analysis Date:	11/04/16		Preparation Date: 11/04/16			
	Lead		<0.005	0.005	mg/L	
16-6253-010	DGS-5B	Date Collected: 11/02/16	Time Collected:			
Analysis Date:	11/04/16		Preparation Date: 11/04/16			
	Lead		<0.005	0.005	mg/L	

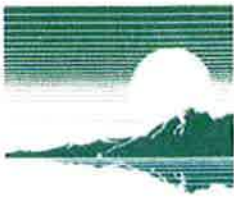

Analytical Report

Client: WIGHT & COMPANY
Project ID: 05-5274-34 DGS High School Kitchen

Date Received: 11/03/16
Date Reported: 11/07/16

Lab No:	Sample ID:	Analyte	Result	R.L.	Units	Flags
16-6253-011	DGS-6A		Date Collected: 11/02/16	Time Collected:		
	Analysis Date: 11/04/16			Preparation Date: 11/04/16		
		Lead	0.008	0.005	mg/L	
16-6253-012	DGS-6B		Date Collected: 11/02/16	Time Collected:		
	Analysis Date: 11/04/16			Preparation Date: 11/04/16		
		Lead	<0.005	0.005	mg/L	
16-6253-013	DGS-7A		Date Collected: 11/02/16	Time Collected:		
	Analysis Date: 11/04/16			Preparation Date: 11/04/16		
		Lead	<0.005	0.005	mg/L	
16-6253-014	DGS-7B		Date Collected: 11/02/16	Time Collected:		
	Analysis Date: 11/04/16			Preparation Date: 11/04/16		
		Lead	<0.005	0.005	mg/L	
16-6253-015	DGS-8A		Date Collected: 11/02/16	Time Collected:		
	Analysis Date: 11/04/16			Preparation Date: 11/04/16		
		Lead	<0.005	0.005	mg/L	
16-6253-016	DGS-8B		Date Collected: 11/02/16	Time Collected:		
	Analysis Date: 11/04/16			Preparation Date: 11/04/16		
		Lead	<0.005	0.005	mg/L	
16-6253-017	DGS-9A		Date Collected: 11/02/16	Time Collected:		
	Analysis Date: 11/04/16			Preparation Date: 11/04/16		
		Lead	<0.005	0.005	mg/L	
16-6253-018	DGS-9B		Date Collected: 11/02/16	Time Collected:		
	Analysis Date: 11/04/16			Preparation Date: 11/04/16		
		Lead	<0.005	0.005	mg/L	
16-6253-019	DGS-10A		Date Collected: 11/02/16	Time Collected:		
	Analysis Date: 11/04/16			Preparation Date: 11/04/16		
		Lead	<0.005	0.005	mg/L	
16-6253-020	DGS-10B		Date Collected: 11/02/16	Time Collected:		
	Analysis Date: 11/04/16			Preparation Date: 11/04/16		
		Lead	<0.005	0.005	mg/L	



Analytical Report

Client: WIGHT & COMPANY
Project ID: 05-5274-34 DGS High School Kitchen

Date Received: 11/03/16
Date Reported: 11/07/16

Lab No:	Sample ID:	Analyte	Result	R.L.	Units	Flags
16-6253-021	DGS-11A					
			Date Collected: 11/02/16		Time Collected:	
			Preparation Date: 11/04/16			
Analysis Date:	11/04/16					
		Lead	<0.005	0.005	mg/L	
16-6253-022	DGS-11B					
			Date Collected: 11/02/16		Time Collected:	
			Preparation Date: 11/04/16			
Analysis Date:	11/04/16					
		Lead	<0.005	0.005	mg/L	
16-6253-023	DGS-12A					
			Date Collected: 11/02/16		Time Collected:	
			Preparation Date: 11/04/16			
Analysis Date:	11/04/16					
		Lead	<0.005	0.005	mg/L	
16-6253-024	DGS-12B					
			Date Collected: 11/02/16		Time Collected:	
			Preparation Date: 11/04/16			
Analysis Date:	11/04/16					
		Lead	<0.005	0.005	mg/L	
16-6253-025	DGS-13A					
			Date Collected: 11/02/16		Time Collected:	
			Preparation Date: 11/04/16			
Analysis Date:	11/04/16					
		Lead	<0.005	0.005	mg/L	
16-6253-026	DGS-13B					
			Date Collected: 11/02/16		Time Collected:	
			Preparation Date: 11/04/16			
Analysis Date:	11/04/16					
		Lead	<0.005	0.005	mg/L	
16-6253-027	DGS-14A					
			Date Collected: 11/02/16		Time Collected:	
			Preparation Date: 11/04/16			
Analysis Date:	11/04/16					
		Lead	<0.005	0.005	mg/L	
16-6253-028	DGS-14B					
			Date Collected: 11/02/16		Time Collected:	
			Preparation Date: 11/04/16			
Analysis Date:	11/04/16					
		Lead	<0.005	0.005	mg/L	
16-6253-029	DGS-15A					
			Date Collected: 11/02/16		Time Collected:	
			Preparation Date: 11/04/16			
Analysis Date:	11/04/16					
		Lead	<0.005	0.005	mg/L	
16-6253-030	DGS-15B					
			Date Collected: 11/02/16		Time Collected:	
			Preparation Date: 11/04/16			
Analysis Date:	11/04/16					
		Lead	<0.005	0.005	mg/L	

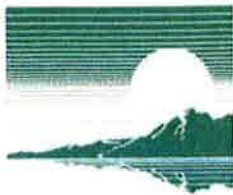

Analytical Report

Client: WIGHT & COMPANY
Project ID: 05-5274-34 DGS High School Kitchen

Date Received: 11/03/16
Date Reported: 11/07/16

Lab No:	Sample ID:	Analyte	Result	R.L.	Units	Flags
16-6253-031	DGS-16A		Date Collected: 11/02/16	Time Collected:		
	Analysis Date: 11/04/16			Preparation Date: 11/04/16		
		Lead	<0.005	0.005	mg/L	
16-6253-032	DGS-16B		Date Collected: 11/02/16	Time Collected:		
	Analysis Date: 11/04/16			Preparation Date: 11/04/16		
		Lead	<0.005	0.005	mg/L	
16-6253-033	DGS-17A		Date Collected: 11/02/16	Time Collected:		
	Analysis Date: 11/04/16			Preparation Date: 11/04/16		
		Lead	<0.005	0.005	mg/L	
16-6253-034	DGS-17B		Date Collected: 11/02/16	Time Collected:		
	Analysis Date: 11/04/16			Preparation Date: 11/04/16		
		Lead	<0.005	0.005	mg/L	
16-6253-035	DGS-18A		Date Collected: 11/02/16	Time Collected:		
	Analysis Date: 11/04/16			Preparation Date: 11/04/16		
		Lead	<0.005	0.005	mg/L	
16-6253-036	DGS-18B		Date Collected: 11/02/16	Time Collected:		
	Analysis Date: 11/04/16			Preparation Date: 11/04/16		
		Lead	<0.005	0.005	mg/L	
16-6253-037	DGS-19A		Date Collected: 11/02/16	Time Collected:		
	Analysis Date: 11/04/16			Preparation Date: 11/04/16		
		Lead	<0.005	0.005	mg/L	
16-6253-038	DGS-19B		Date Collected: 11/02/16	Time Collected:		
	Analysis Date: 11/04/16			Preparation Date: 11/04/16		
		Lead	<0.005	0.005	mg/L	
16-6253-039	DGS-20A		Date Collected: 11/02/16	Time Collected:		
	Analysis Date: 11/04/16			Preparation Date: 11/04/16		
		Lead	<0.005	0.005	mg/L	
16-6253-040	DGS-20B		Date Collected: 11/02/16	Time Collected:		
	Analysis Date: 11/04/16			Preparation Date: 11/04/16		
		Lead	<0.005	0.005	mg/L	

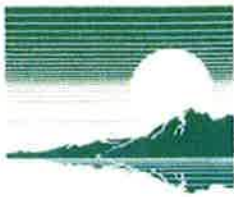

**First
Environmental
Laboratories, Inc.**

IL ELAP / NELAC Accreditation # 100292
1600 Shore Road • Naperville, Illinois 60563 • Phone (630) 778-1200 • Fax (630) 778-1233

Analytical Report

Client: WIGHT & COMPANY
Project ID: 05-5274-34 DGS High School Kitchen

Date Received: 11/03/16
Date Reported: 11/07/16

Lab No:	Sample ID:	Analyte	Result	R.L.	Units	Flags
16-6253-041	DGS-21A		Date Collected: 11/02/16	Time Collected:		
	Analysis Date: 11/04/16			Preparation Date: 11/04/16		
		Lead	<0.005	0.005	mg/L	
16-6253-042	DGS-21B		Date Collected: 11/02/16	Time Collected:		
	Analysis Date: 11/04/16			Preparation Date: 11/04/16		
		Lead	<0.005	0.005	mg/L	
16-6253-043	DGS-22A		Date Collected: 11/02/16	Time Collected:		
	Analysis Date: 11/04/16			Preparation Date: 11/04/16		
		Lead	<0.005	0.005	mg/L	
16-6253-044	DGS-22B		Date Collected: 11/02/16	Time Collected:		
	Analysis Date: 11/04/16			Preparation Date: 11/04/16		
		Lead	<0.005	0.005	mg/L	
16-6253-045	DGS-23A		Date Collected: 11/02/16	Time Collected:		
	Analysis Date: 11/04/16			Preparation Date: 11/04/16		
		Lead	<0.005	0.005	mg/L	
16-6253-046	DGS-23B		Date Collected: 11/02/16	Time Collected:		
	Analysis Date: 11/04/16			Preparation Date: 11/04/16		
		Lead	<0.005	0.005	mg/L	
16-6253-047	DGS-24A		Date Collected: 11/02/16	Time Collected:		
	Analysis Date: 11/04/16			Preparation Date: 11/04/16		
		Lead	<0.005	0.005	mg/L	
16-6253-048	DGS-24B		Date Collected: 11/02/16	Time Collected:		
	Analysis Date: 11/04/16			Preparation Date: 11/04/16		
		Lead	<0.005	0.005	mg/L	



CHAIN OF CUSTODY RECORD

First Environmental Laboratories, Inc.

1600 Shore Road, Suite D
Naperville, Illinois 60563
Phone: (630) 778-1200 • Fax: (630) 778-1233
E-mail: firstinfo@firstenv.com
IEPA Certification #100292

Company Name: WIGGAT & COMPANY

Street Address:

City:

State:

Zip:

Phone:

e-mail: RGENSEN@RREEK@W14HTCO.COM

Send Report To:

ROGER GENSCHOR ECK

Sampled By:

R. Amundson

Analyses

Date/Time Taken	Sample Description	Matrix	Comments	Lab I.D.
11/2/2016	DGS-1A	W		16-16253-001
	-1B			002
	-2A-			003
	-2B			004
	-3A			005
	-3B			006
	-4A			007
	-4B			008
	-5A			009
	-5B			010
	-6A			011
	-6B			012

Project ID: OS-5274-34 DOWNERS GROVE SOUTH
HIGH SCHOOL KITCHEN
LEARN WARD

P.O. #: OS-5274-34

Matrix Codes: S = Soil W = Water O = Other

FOR LAB USE ONLY:

Cooler Temperature: 0.1-6°C Yes No °C
Received within 6 hrs. of collection: _____
Ice Present: Yes No

Sample Refrigerated: Yes No

Refrigerator Temperature: _____ °C

5035 Vials Frozen: Yes No

Freezer Temperature: _____ °C

Notes and Special Instructions:

A-137 DRAW
B-2 NO DRAW

Relinquished By: R. Amundson

Date/Time: 11-3-16 0955

Received By: NR

Date/Time: 11-3-16 0950

Relinquished By: _____

Date/Time: _____

Received By: _____

Date/Time: _____



CHAIN OF CUSTODY RECORD

First Environmental Laboratories, Inc.

First Environmental Laboratories
1600 Shore Road, Suite D
Naperville, Illinois 60563
Phone: (630) 778-1200 • Fax: (630) 778-1233
E-mail: fristenv@fristenv.com
IEPA Certification #100292

Company Name: WIGAT COMPANY

Street Address:

City:

State:

Zip:

Phone:

e-mail: REGENSCHADRECK@WIGATCO.COM

Send Report To:

Sampled By:

Analyses

Project I.D.: 05-5274-34 DOWNERS GROVE SOUTH
HIGH SCHOOL KITCHEN
P.O. #: 05-5274-34

Date/Time Taken	Sample Description	Matrix	Comments	Lab I.D.
11/2/2016	DGS-7A	W		16-1153-013
	7B			014
	8-A			015
	8-B			016
	9-A			017
	9-B			018
	10-A			019
	10-B			020
	11-A			021
	11-B			022
	12-A			023
	12-B			024

FOR LAB USE ONLY:

Cooler Temperature: 0-16°C Yes No °C
Received within 6 hrs. of collection: _____
Ice Present: Yes No

Sample Refrigerated: Yes No

Refrigerator Temperature: _____ °C

5035 Vials Frozen: Yes No

Freezer Temperature: _____ °C

Notes and Special Instructions: A 1ST DRAW
B 2ND DRAW

Relinquished By: R Amchoub Date/Time 11-3-16 09:50 Received By: My Date/Time 11-3-16 09:50

Relinquished By: _____ Date/Time _____ Received By: _____ Date/Time _____



First Environmental Laboratories, Inc.

First Environmental Laboratories
1600 Shore Road, Suite D
Naperville, Illinois 60563
Phone: (630) 778-1200 • Fax: (630) 778-1233
E-mail: firstinfo@firstenv.com
IEPA Certification #100292

CHAIN OF CUSTODY RECORD

Company Name: WIGGITT & COMPANY
Street Address: _____
City: _____ State: _____ Zip: _____
Phone: _____ e-mail: _____
Send Report To: _____
Sampled By: _____

Matrix Codes: S = Soil W = Water O = Other		Analyses	
Date/Time Taken	Sample Description	Matrix	Lab I.D.
11/2/2016	045 - 13A 13B 14A 14B 15A 15B 16A 16B 17A 17B 18A 18B	W	110-6253-025 026 027 028 029 030 031 032 033 034 035 036
Hold - Do Not Analyze			

Project ID: 05-5274-34 DOWNERS GROVE SOUTH
NIGHT SECTOR KITCHEN (LGA)

P.O. #: 05-5274-34

FOR LAB USE ONLY:

Cooler Temperature: 0.1-6°C Yes No °C
Refrigerator Temperature: _____ °C
Refrigerator Frozen: Yes No °C
Freezer Temperature: _____ °C

Sample Refrigerated: Yes No
Program: TACO CC3D NPDES LUST

Notes and Special Instructions: A. 1st DRAW
B. 2nd DRAW

Relinquished By: R. Amchorn Date/Time: 11-3-16 0930 Received By: MLZ Date/Time: 11-3-16 0950
Relinquished By: _____ Date/Time: _____ Received By: _____ Date/Time: _____



First Environmental Laboratories
 1600 Shore Road, Suite D
 Naperville, Illinois 60563
 Phone: (630) 778-1200 • Fax: (630) 778-1233
 E-mail: firstinfo@firstenv.com
 IEPA Certification #100292

CHAIN OF CUSTODY RECORD

Company Name: WILITT & COMPANY

Street Address:

City:

State:

Zip:

Phone:

Send Report To:

Sampled By: R Amichant

Analyses

Matrix Codes: S = Soil W = Water O = Other		Sample Description	Matrix	Comments	Lab I.D.
Date/Time Taken					
<u>11/2/2016</u>	<u>D&S-19A</u>	<u>19B</u>	<u>W</u>		<u>16-6283-37</u>
		<u>20A</u>			<u>038</u>
		<u>20B</u>			<u>039</u>
		<u>21A</u>			<u>040</u>
		<u>21B</u>			<u>041</u>
		<u>22A</u>			<u>042</u>
		<u>22B</u>			<u>043</u>
		<u>23A</u>			<u>044</u>
		<u>23B</u>			<u>045</u>
		<u>24A</u>			<u>046</u>
		<u>24B</u>			<u>047</u>
					<u>048</u>

Hold - Do Not Analyze

END
 P&E
 Hill School Kitchen

Project I.D. 05-5274-34 OWNERS GROVE SOUTH

P.O. # 05-5274-34

FOR LAB USE ONLY:

Cooler Temperature: 0.1-6°C Yes No Sample Refrigerated: Yes No LUST
 Refrigerator Temperature: _____ °C
 Received within 6 hrs. of collection: _____
 Ice Present: Yes No 5035 Vials Frozen: Yes No
 Freezer Temperature: _____ °C

Program: TACO CCDD INPDES LUST

Notes and Special Instructions: A - 1 ST DRAW
B 2ND DRAW

Relinquished By: R Amichant Date/Time 11-3-16 2:50 Received By: MZ Date/Time 11-3-16 0:10

Relinquished By: _____ Date/Time _____ Received By: _____ Date/Time _____

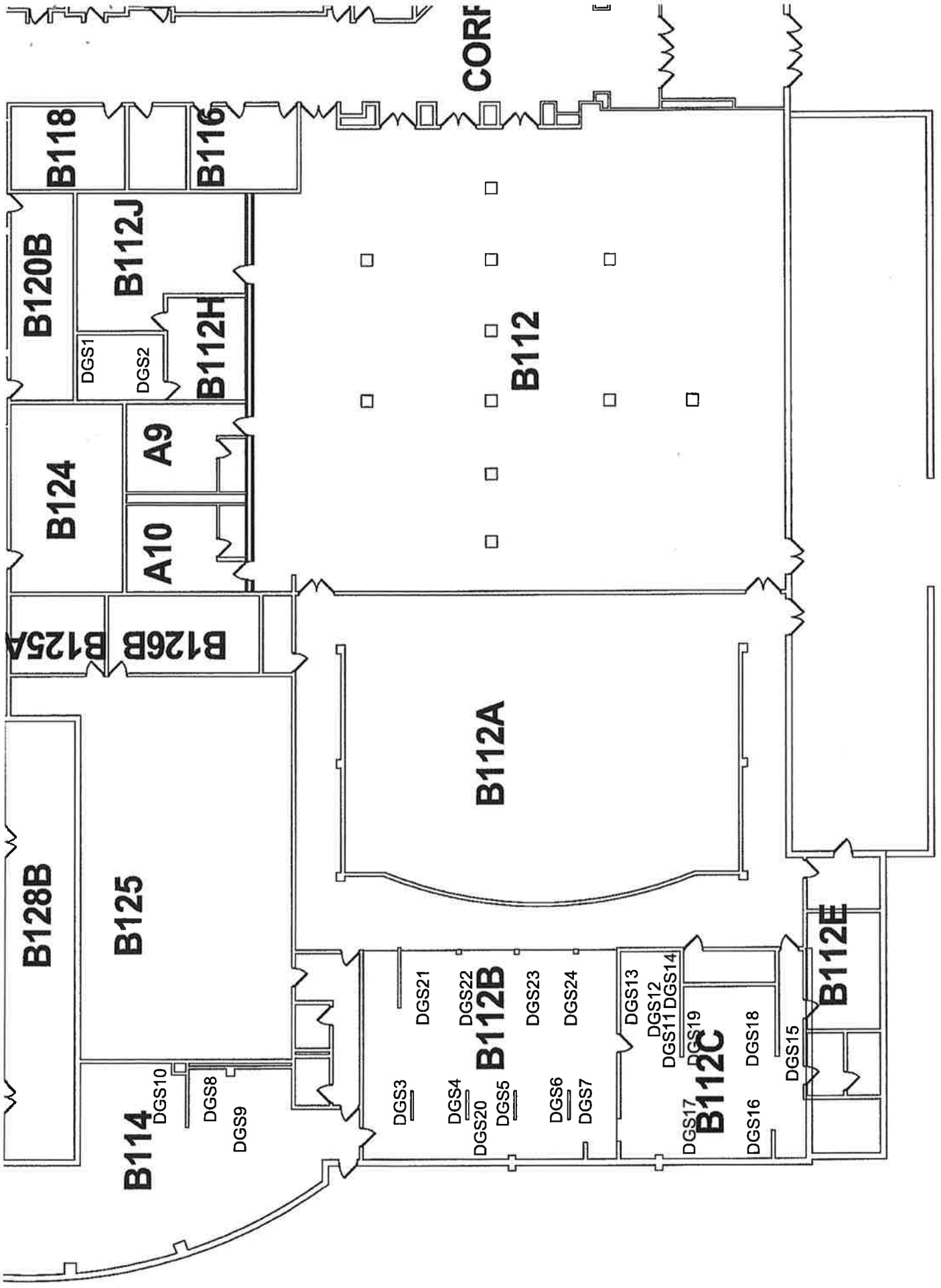

Downers Grove South Kitchen Lead In Potable Water Sample Locations

Wight & Company Darien, Illinois 05-5274-34