



Wight & Company

wightco.com

.....
2500 North Frontage Road

Darien, IL 60561

.....
P 630.969.7000

F 630.969.7979

November 7, 2016

Mr. James Kolodziej
Director of Physical Plant & Operations/Purchasing
Community High School District #99
6301 Springside Avenue
Downers Grove, IL 60516

**LEAD IN POTABLE WATER STUDY
DOWNERS GROVE NORTH HIGH SCHOOL**

Dear Mr. Kolodziej:

Wight & Company was retained by Community High School District #99 to provide a limited lead in potable water study for Downers Grove North High School kitchen and serving area.

The health effects of lead in the body can cause serious damage to all of the systems. The three most affected systems are the central and peripheral nervous system, cardiovascular system and the kidneys. Excessive exposure to high concentrations of lead can cause retardation (learning disabilities) and more serious health problems. Children are the most susceptible to lead poisoning. The "United States Environmental Protection Agency" (USEPA) has established an action level of 15 PPB (parts per billion) of lead in water as the maximum safe level for potable water consumption by humans.

Sampling was conducted at the facility in accordance with established protocol. At the facility no water was used for several hours prior to the sampling, which allows for leaching of lead from the valves or piping into the water. After the waiting period, the method was to obtain a first draw of one liter of water followed by a second draw of 250ml of water immediately following the first draw at each location where drinking water could be consumed. The samples were transported to First Environmental Laboratories, Inc. in Naperville an IL ELAP/NELAC accredited laboratory for analysis of lead in water.

The results indicated all of the faucets sampled were $<.005$ mg/L (less than) or expressed in parts per billion <5 PPB. The results are that all sources sampled are in compliance with <15 PPB. Please refer to the facilities laboratory results attached.

Thank you for having Wight & Company provide this important service to Community High School District #99.

Respectfully Submitted,

Roger Genschoreck
IDPH Lead Inspector #007300

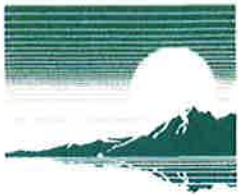

**First
Environmental
Laboratories, Inc.**

IL ELAP / NELAC Accreditation # 100292

1600 Shore Road • Naperville, Illinois 60563 • Phone (630) 778-1200 • Fax (630) 778-1233

November 07, 2016

Mr. Roger Genschoreck
WIGHT & COMPANY
2500 N. Frontage Rd.
Darien, IL 60561

Project ID: 05-5274-34 DGN High School Kitchen
First Environmental File ID: 16-6252
Date Received: November 03, 2016

Dear Mr. Roger Genschoreck:

The above referenced project was analyzed as directed on the enclosed chain of custody record.

All Quality Control criteria as outlined in the methods and current IL ELAP/NELAP have been met unless otherwise noted. QA/QC documentation and raw data will remain on file for future reference. Our accreditation number is 100292 and our current certificate is number 003811: effective 02/17/2016 through 02/28/2017.

I thank you for the opportunity to be of service to you and look forward to working with you again in the future. Should you have any questions regarding any of the enclosed analytical data or need additional information, please contact me at (630) 778-1200.

Sincerely,



Stan Zaworski
Project Manager

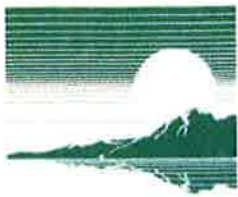

Case Narrative

WIGHT & COMPANY

Lab File ID: **16-6252**

Project ID: **05-5274-34 DGN High School Kitchen**

Date Received: **November 03, 2016**

All quality control criteria, as outlined in the methods, have been met except as noted below or on the following analytical report.

The results in this report apply to the samples in the following table:

Laboratory Sample ID	Client Sample Identifier	Date/Time Collected
16-6252-001	DGN-1A	11/2/2016
16-6252-002	DGN-1B	11/2/2016
16-6252-003	DGN-2A	11/2/2016
16-6252-004	DGN-2B	11/2/2016
16-6252-005	DGN-3A	11/2/2016
16-6252-006	DGN-3B	11/2/2016
16-6252-007	DGN-4A	11/2/2016
16-6252-008	DGN-4B	11/2/2016
16-6252-009	DGN-5A	11/2/2016
16-6252-010	DGN-5B	11/2/2016
16-6252-011	DGN-6A	11/2/2016
16-6252-012	DGN-6B	11/2/2016
16-6252-013	DGN-7A	11/2/2016
16-6252-014	DGN-7B	11/2/2016
16-6252-015	DGN-8A	11/2/2016
16-6252-016	DGN-8B	11/2/2016
16-6252-017	DGN-9A	11/2/2016
16-6252-018	DGN-9B	11/2/2016
16-6252-019	DGN-10A	11/2/2016
16-6252-020	DGN-10B	11/2/2016
16-6252-021	DGN-11A	11/2/2016
16-6252-022	DGN-11B	11/2/2016
16-6252-023	DGN-12A	11/2/2016
16-6252-024	DGN-12B	11/2/2016

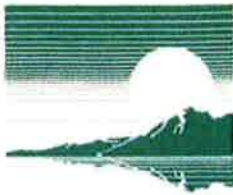

Case Narrative

WIGHT & COMPANY

Lab File ID: **16-6252**

Project ID: **05-5274-34 DGN High School Kitchen**

Date Received: **November 03, 2016**

All quality control criteria, as outlined in the methods, have been met except as noted below or on the following analytical report.

Sample Batch Comments:

Time of sample collection was not provided.

Method Comments

Lab Number	Sample ID	Comments:
16-6252-019	DGN-10A	<i>Total Metals</i> Sample result was confirmed by re-analysis.

The following is a definition of flags that may be used in this report:

Flag	Description	Flag	Description
<	Analyte not detected at or above the reporting limit.	L	LCS recovery outside control limits.
C	Sample received in an improper container for this test.	M	MS recovery outside control limits; LCS acceptable.
D	Surrogates diluted out; recovery not available.	P	Chemical preservation pH adjusted in lab.
E	Estimated result; concentration exceeds calibration range.	Q	Result was determined by a GC/MS database search.
G	Surrogate recovery outside control limits.	S	Analysis was subcontracted to another laboratory.
H	Analysis or extraction holding time exceeded.	W	Reporting limit elevated due to sample matrix.
J	Estimated result; concentration is less than routine RL but greater than MDL.	N	Analyte is not part of our NELAC accreditation or accreditation may not be available for this parameter.
RL	Routine Reporting Limit (Lowest amount that can be detected when routine weights/volumes are used without dilution.)	ND	Analyte was not detected using a library search routine; No calibration standard was analyzed.

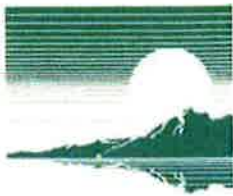

Analytical Report

Client: WIGHT & COMPANY
Project ID: 05-5274-34 DGN High School Kitchen

Date Received: 11/03/16
Date Reported: 11/07/16

Lab No:	Sample ID:	Analyte	Result	R.L.	Units	Flags
Total Metals		Method: 200.7R4.4	Preparation Method 200.7W			
16-6252-001	DGN-1A		Date Collected: 11/02/16	Time Collected:		
	Analysis Date: 11/03/16			Preparation Date: 11/04/16		
		Lead	<0.005	0.005	mg/L	
16-6252-002	DGN-1B		Date Collected: 11/02/16	Time Collected:		
	Analysis Date: 11/03/16			Preparation Date: 11/04/16		
		Lead	<0.005	0.005	mg/L	
16-6252-003	DGN-2A		Date Collected: 11/02/16	Time Collected:		
	Analysis Date: 11/03/16			Preparation Date: 11/04/16		
		Lead	<0.005	0.005	mg/L	
16-6252-004	DGN-2B		Date Collected: 11/02/16	Time Collected:		
	Analysis Date: 11/03/16			Preparation Date: 11/04/16		
		Lead	<0.005	0.005	mg/L	
16-6252-005	DGN-3A		Date Collected: 11/02/16	Time Collected:		
	Analysis Date: 11/03/16			Preparation Date: 11/04/16		
		Lead	<0.005	0.005	mg/L	
16-6252-006	DGN-3B		Date Collected: 11/02/16	Time Collected:		
	Analysis Date: 11/03/16			Preparation Date: 11/04/16		
		Lead	<0.005	0.005	mg/L	
16-6252-007	DGN-4A		Date Collected: 11/02/16	Time Collected:		
	Analysis Date: 11/03/16			Preparation Date: 11/04/16		
		Lead	<0.005	0.005	mg/L	
16-6252-008	DGN-4B		Date Collected: 11/02/16	Time Collected:		
	Analysis Date: 11/03/16			Preparation Date: 11/04/16		
		Lead	<0.005	0.005	mg/L	
16-6252-009	DGN-5A		Date Collected: 11/02/16	Time Collected:		
	Analysis Date: 11/03/16			Preparation Date: 11/04/16		
		Lead	<0.005	0.005	mg/L	
16-6252-010	DGN-5B		Date Collected: 11/02/16	Time Collected:		
	Analysis Date: 11/03/16			Preparation Date: 11/04/16		
		Lead	<0.005	0.005	mg/L	

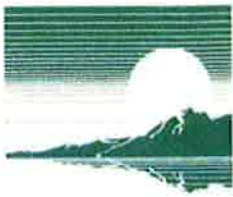

Analytical Report

Client: WIGHT & COMPANY
Project ID: 05-5274-34 DGN High School Kitchen

Date Received: 11/03/16
Date Reported: 11/07/16

Lab No:	Sample ID:	Analyte	Result	R.L.	Units	Flags
16-6252-011	DGN-6A		Date Collected: 11/02/16	Time Collected:		
	Analysis Date: 11/03/16			Preparation Date: 11/04/16		
		Lead	<0.005	0.005	mg/L	
16-6252-012	DGN-6B		Date Collected: 11/02/16	Time Collected:		
	Analysis Date: 11/03/16			Preparation Date: 11/04/16		
		Lead	<0.005	0.005	mg/L	
16-6252-013	DGN-7A		Date Collected: 11/02/16	Time Collected:		
	Analysis Date: 11/03/16			Preparation Date: 11/04/16		
		Lead	<0.005	0.005	mg/L	
16-6252-014	DGN-7B		Date Collected: 11/02/16	Time Collected:		
	Analysis Date: 11/03/16			Preparation Date: 11/04/16		
		Lead	<0.005	0.005	mg/L	
16-6252-015	DGN-8A		Date Collected: 11/02/16	Time Collected:		
	Analysis Date: 11/03/16			Preparation Date: 11/04/16		
		Lead	<0.005	0.005	mg/L	
16-6252-016	DGN-8B		Date Collected: 11/02/16	Time Collected:		
	Analysis Date: 11/03/16			Preparation Date: 11/04/16		
		Lead	<0.005	0.005	mg/L	
16-6252-017	DGN-9A		Date Collected: 11/02/16	Time Collected:		
	Analysis Date: 11/03/16			Preparation Date: 11/04/16		
		Lead	<0.005	0.005	mg/L	
16-6252-018	DGN-9B		Date Collected: 11/02/16	Time Collected:		
	Analysis Date: 11/03/16			Preparation Date: 11/04/16		
		Lead	<0.005	0.005	mg/L	
16-6252-019	DGN-10A		Date Collected: 11/02/16	Time Collected:		
	Analysis Date: 11/03/16			Preparation Date: 11/04/16		
		Lead	0.007	0.005	mg/L	
16-6252-020	DGN-10B		Date Collected: 11/02/16	Time Collected:		
	Analysis Date: 11/03/16			Preparation Date: 11/04/16		
		Lead	<0.005	0.005	mg/L	

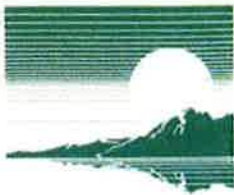

Analytical Report

Client: WIGHT & COMPANY
Project ID: 05-5274-34 DGN High School Kitchen

Date Received: 11/03/16
Date Reported: 11/07/16

Lab No:	Sample ID:	Analyte	Result	R.L.	Units	Flags
16-6252-021	DGN-11A		Date Collected: 11/02/16	Time Collected:		
	Analysis Date: 11/03/16			Preparation Date: 11/04/16		
		Lead	<0.005	0.005	mg/L	
16-6252-022	DGN-11B		Date Collected: 11/02/16	Time Collected:		
	Analysis Date: 11/03/16			Preparation Date: 11/04/16		
		Lead	<0.005	0.005	mg/L	
16-6252-023	DGN-12A		Date Collected: 11/02/16	Time Collected:		
	Analysis Date: 11/03/16			Preparation Date: 11/04/16		
		Lead	<0.005	0.005	mg/L	
16-6252-024	DGN-12B		Date Collected: 11/02/16	Time Collected:		
	Analysis Date: 11/03/16			Preparation Date: 11/04/16		
		Lead	<0.005	0.005	mg/L	



First Environmental Laboratories, Inc.

First Environmental Laboratories
 1600 Shore Road, Suite D
 Naperville, Illinois 60563
 Phone: (630) 778-1200 • Fax: (630) 778-1233
 E-mail: firstinfo@firstenv.com
 IEPA Certification #100292

CHAIN OF CUSTODY RECORD

Company Name: WIGHT & COMPANY

Street Address: _____

City: _____

State: _____

Zip: _____

Phone: 630-918-6606 ext: mail

RGENSECKHORECK @ WIGHT CO. COM

Send Report To: ROGER GENSECKHORECK

Sampled By: R Amick

Analyses

Date/Time Taken	Sample Description	Matrix	Comments	Lab ID.
11/2/2016	D&N-1A	Water		1610252-001
	D&N-1B	W		002
	- 2A			003
	- 2B			004
	- 3A			005
	- 3B			006
	- 4A			007
	- 4B			008
	- 5A			009
	- 5B			010
	- 6A			011
	- 6B			012

FOR LAB USE ONLY:

Cooler Temperature: 0.1-6°C Yes No No 91A °C Sample Refrigerated: Yes No No ✓ °C
 Refrigerator Temperature: _____ °C
 Received within 6 hrs. of collection: _____
 5035 Vials Frozen: Yes No No _____
 Ice Present: Yes No No ✓ Freezer Temperature: _____ °C

Notes and Special Instructions: _____

A - 1st DRAIN
B - 2nd DRAIN

Relinquished By: R Amick Date/Time 11-3-16 0950 Received By: MA Date/Time 11-3-16 0950
 Relinquished By: _____ Date/Time _____ Received By: _____ Date/Time _____



First Environmental Laboratories, Inc.

CHAIN OF CUSTODY RECORD

First Environmental Laboratories

1600 Shore Road, Suite D

Naperville, Illinois 60563

Phone: (630) 778-1200 • Fax: (630) 778-1233

E-mail: firstinfo@firstenv.com

IEPA Certification #100292

Company Name:

WIGHT & COMPANY

Street Address:

City:

Phone:

e-mail:

Send Report To:

Sampled By:

State:

Zip:

Project I.D.: 05-S274-34 DOWNERS GROVE NORTH
 P.O. #: 05-S274-34 1419H SCHOOL KITCHEN

Matrix Codes: S = Soil W = Water O = Other

Date/Time Taken	Sample Description	Matrix	Analyses	Comments	Lab I.D.
11/2/2016	D4N-7A	W			16-6252-013
	7B				014
	8A				015
	8B				016
	9A				017
	9B				018
	10A				019
	10B				020
	11A				021
	11B				022
	12A				023
	12B				024

FOR LAB USE ONLY:

Cooler Temperature: 0-1-6°C Yes No 11A °C

Received within 6 hrs. of collection: _____

Ice Present: Yes No

Sample Refrigerated: Yes No

Refrigerator Temperature: _____ °C

5035 Vials Frozen: Yes No

Freezer Temperature: _____ °C

Program: TACO CCDD NPDES LUST

Notes and Special Instructions:

A - 1ST DRAW
B - 2ND DRAW

Relinquished By: R Amoschuck Date/Time 11-3-16 0950 Received By: NAZ Date/Time 11-3-16 0950

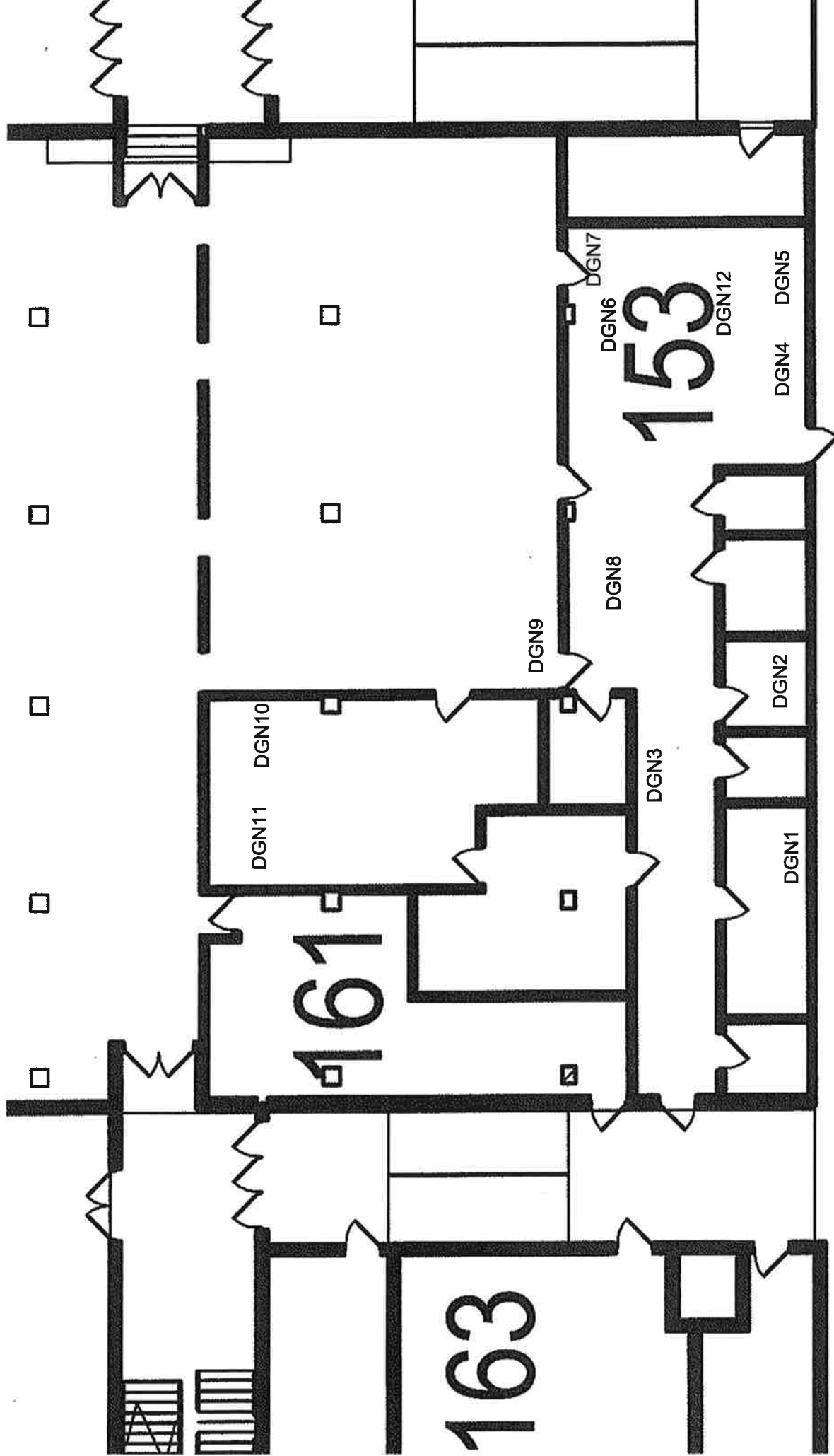

Downers Grove North Kitchen Lead In Potable Water Sample Locations
 Wight & Company Darien, Illinois 05-5274-34